

XIOPTICS RESERVES THE RIGHT TO CHANGE THIS DOCUMENT WITHOUT NOTICE. THIS DOCUMENT IS INTENDED TO AID ONLY IN ORDERING XIOPTICS MATERIALS AND SHOULD BE CONSIDERED FOR REFERENCE ONLY.

$\phi$ .131 [3.33]  
 $\phi$ .127 [3.23]

$\phi$ .123±.002 [3.12±0.05] BONDING CUP ID

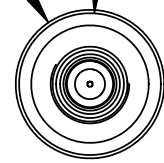

FIBER CABLE BONDING  
SEE TERMINATION INSTRUCTIONS  
FOR PROPER STRIP BACK AND  
PREPARATION. MUST USE ADHESIVE  
LINED SLEEVE FOR PROPER RETENTION

CERAMIC SLEEVE SUB-ASSEMBLY  
AVAILABLE AS SEPARATE ITEM,  
XOHA0001 , SEE NOTE 3

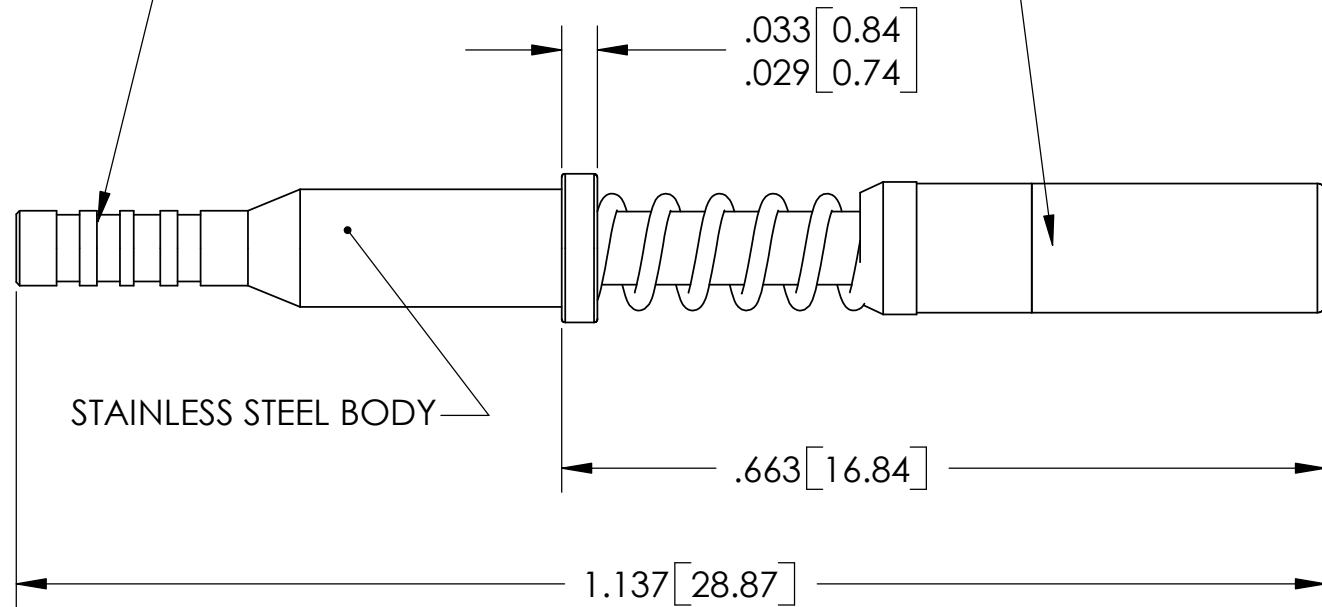

## 29504 STYLE 1 SOCKET ORDERING INFORMATION:

XOS29504-5-SM-900-1255-Q1

P/N	DESCRIPTION
900	900 MICRON JACKET FIBER
2200	1.2MM JACKET FIBER
2200	1.8MM JACKET FIBER
2200	2.0MM JACKET FIBER

Q1: STYLE 1 QPL  
C1: STYLE 1 COTS

P/N	DESCRIPTION
1250	125.0 FERRULE
1255	125.5 FERRULE
1260	126.0 FERRULE
1270	127.0 FERRULE
1560	156.0 FERRULE
1420	142.0 FERRULE
1730	173.0 FERRULE
2360	236.0 FERRULE

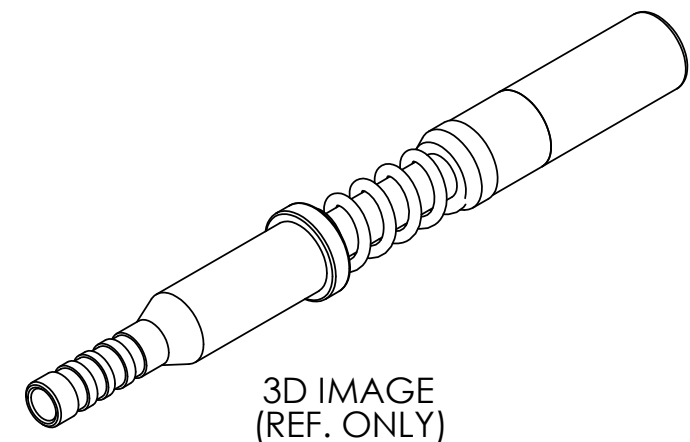

UNLESS OTHER SPECIFIED:

- 1) ALL METALLIC COMPONENTS ARE CRS ALLOY, PASSIVATED
- 2) ALL CERAMIC COMPONENTS ARE ZIRCONIA
- 3) SOCKET ASSEMBLY SHIPPED WITH REMOVAL BE HOOD ASSEMBLY INSTALLED, IF INDIVIDUAL HOOD ASSEMBLIES ARE REQUIRED ORDER P/N XOHA0001

UNLESS OTHERWISE SPECIFIED:		NAME	DATE	<b>XiOptics LLC</b>	
DIMENSIONS ARE IN INCHES AND [MM]		DRAWN	J. B.		
TOLERANCES: ANGULAR: MACH ± 1 BEND ± 3 TWO PLACE DECIMAL ± .01 THREE PLACE DECIMAL ± .005 FOUR PLACE DECIMAL ± .0005		CHECKED			
INTERPRET GEOMETRIC TOLERANCING PER: ANSI Y14.5M		ENG APPR.			
MATERIAL SEE NOTES		MFG APPR.			
FINISH SEE NOTES		Q.A.			SIZE <b>B</b>
DO NOT SCALE DRAWING		COMMENTS:			DWG. NO. XOSA0001CU
					REV CU1
					SCALE: 4:1
					WEIGHT:
					SHEET 1 OF 1